

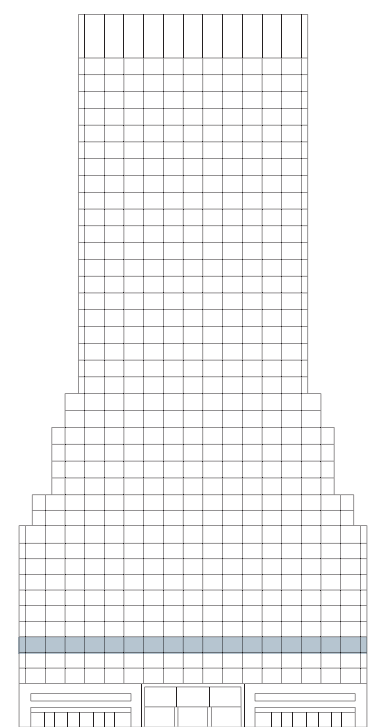

Typical Base Floor Core & Shell

58,767 SQ. FT.
4th Floor

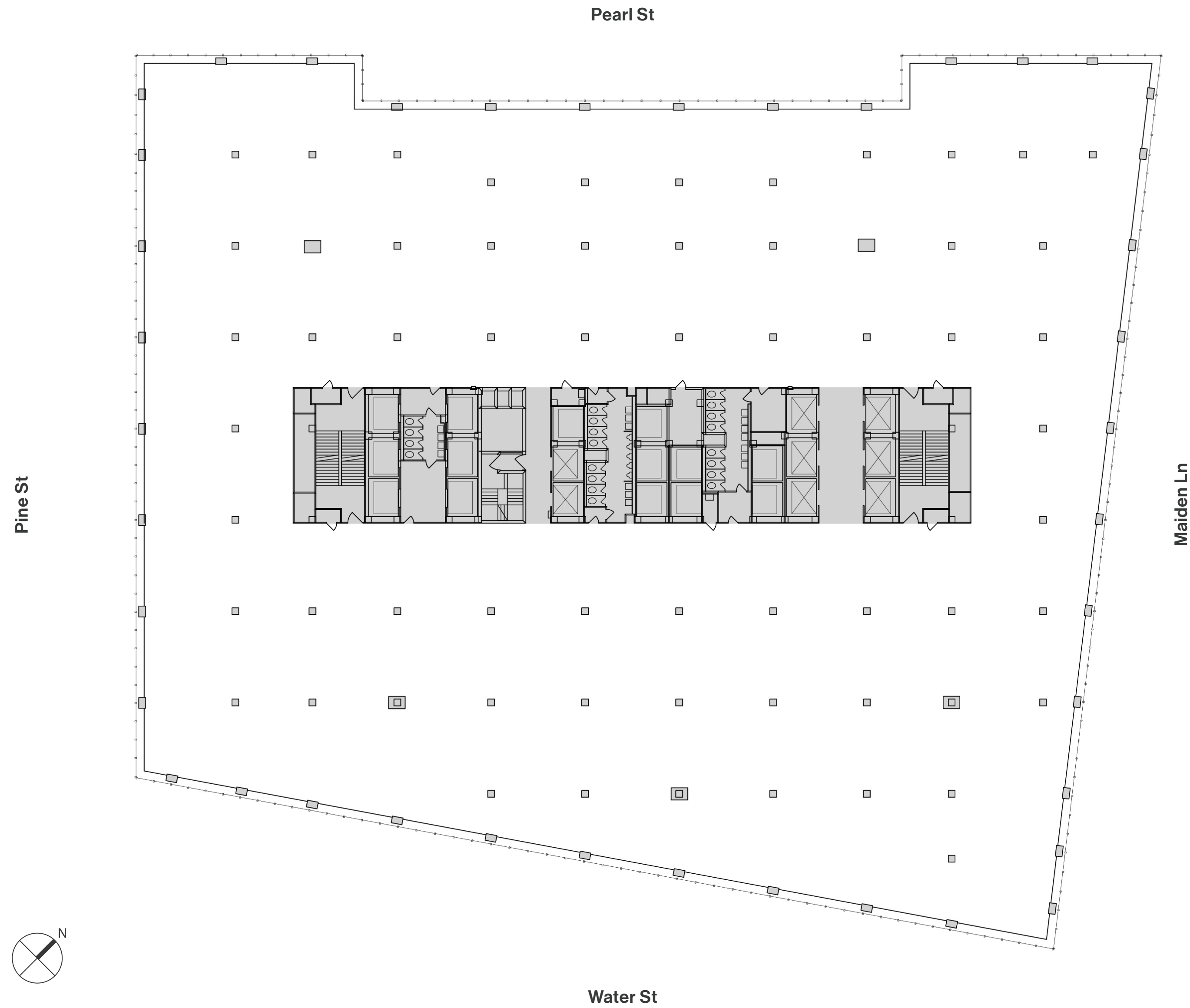

80 Pine



REBNY

Rudín



Typical Base Floor Office Intensive Layout

58,767 SQ. FT.
4th Floor

WORKSPACE	SEATS
Executive Office	1
Private Office	54
Benching (6'0" x 2'6")	208
Reception	1
Total Headcount	264

COLLABORATIVE SPACE	
Boardroom	1
Conference Room	16
Informal Meeting	3
Training Room	1
Phone Room	2

SUPPORT	
Café	1
Pantry	1
Coat Closet	2
Copy	3
IT Room	1
Storage Room	3
Wellness Room	1

80 Pine



REBNY

Pearl St

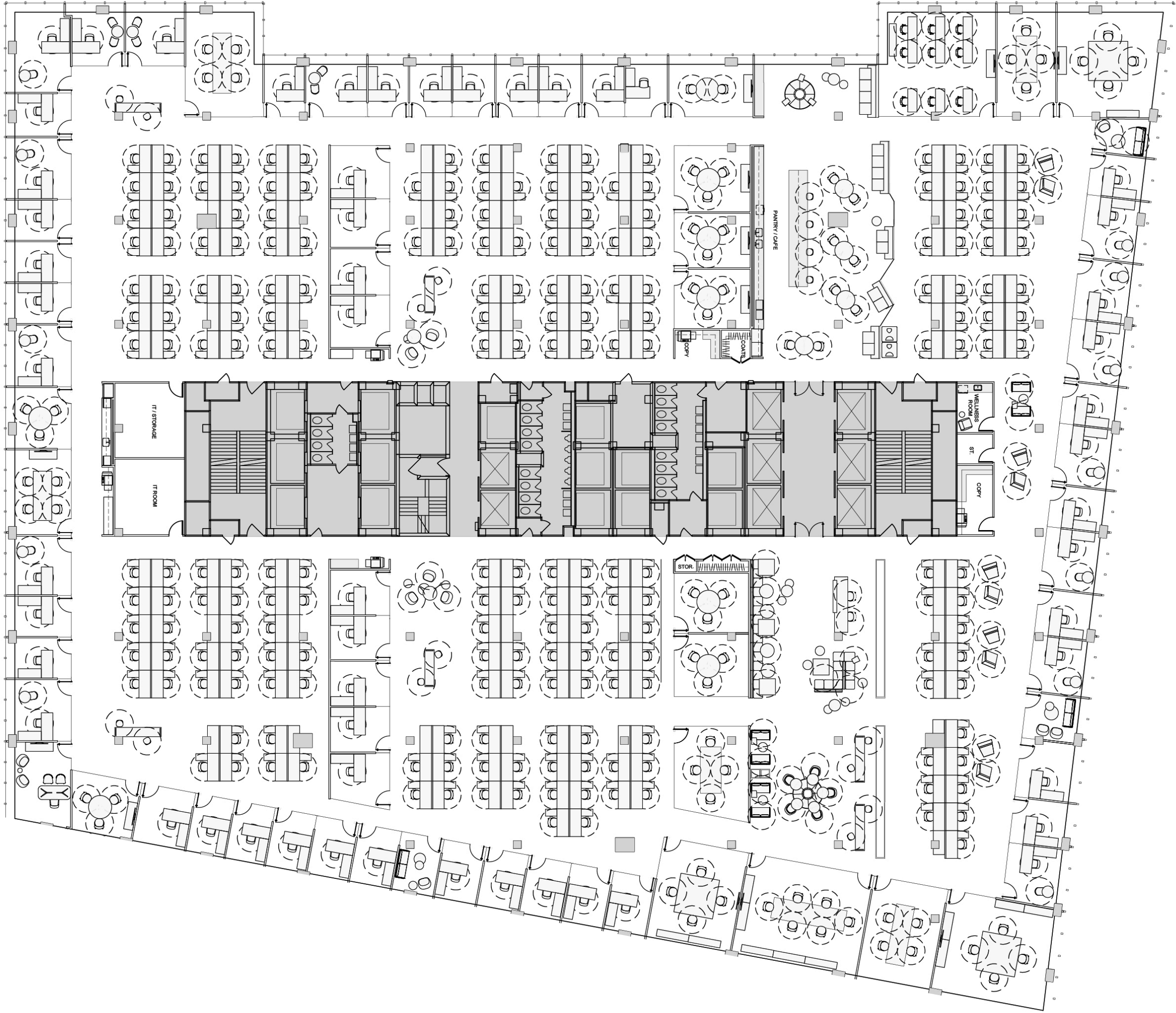

Pine St

Maiden Ln

Water St

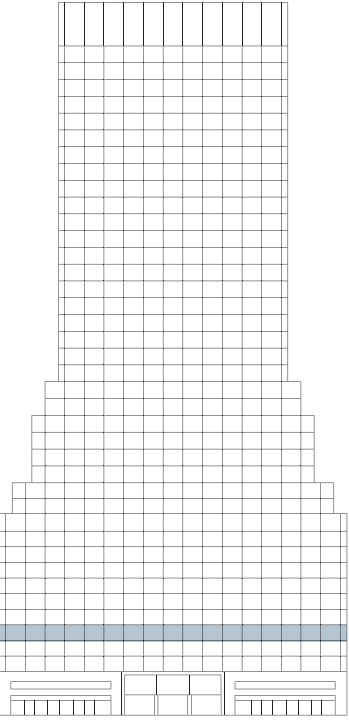

Rudín